



**GOKUL
VRINDAVAN**
An ambience full of love and affection



Single gated township
with **13+** modern amenities

————— 3 BHK PREMIUM FLAT SCHEME —————

WING MADHAV



**GOKUL
VRINDAVAN**
An ambience full of love and affection



2ND TO 6TH TYPICAL FLOOR PLAN

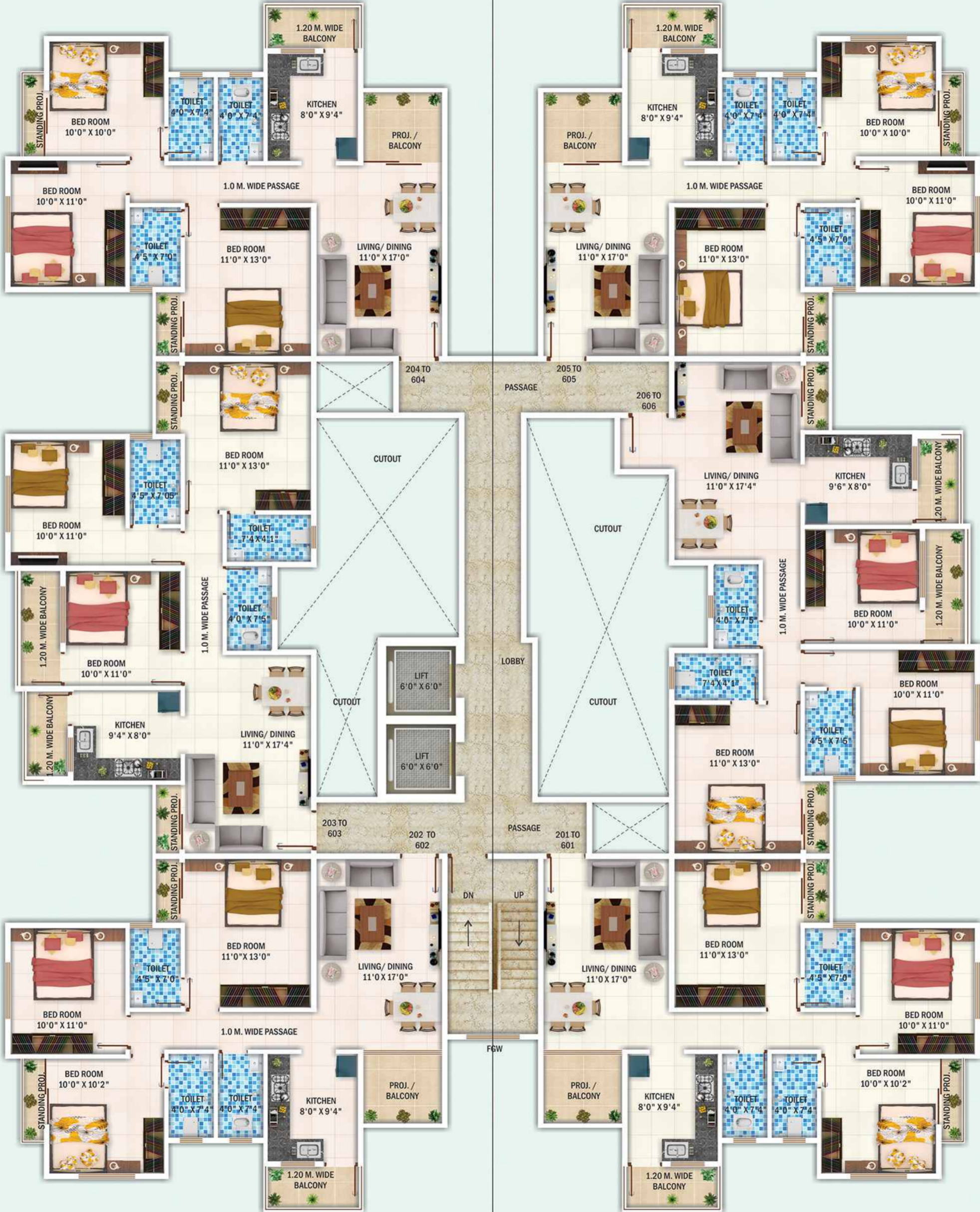

Images used for representation purpose only.



**GOKUL
VRINDAVAN**

An ambience full of love and affection

WING MADHAV





Images used for representation purpose only.

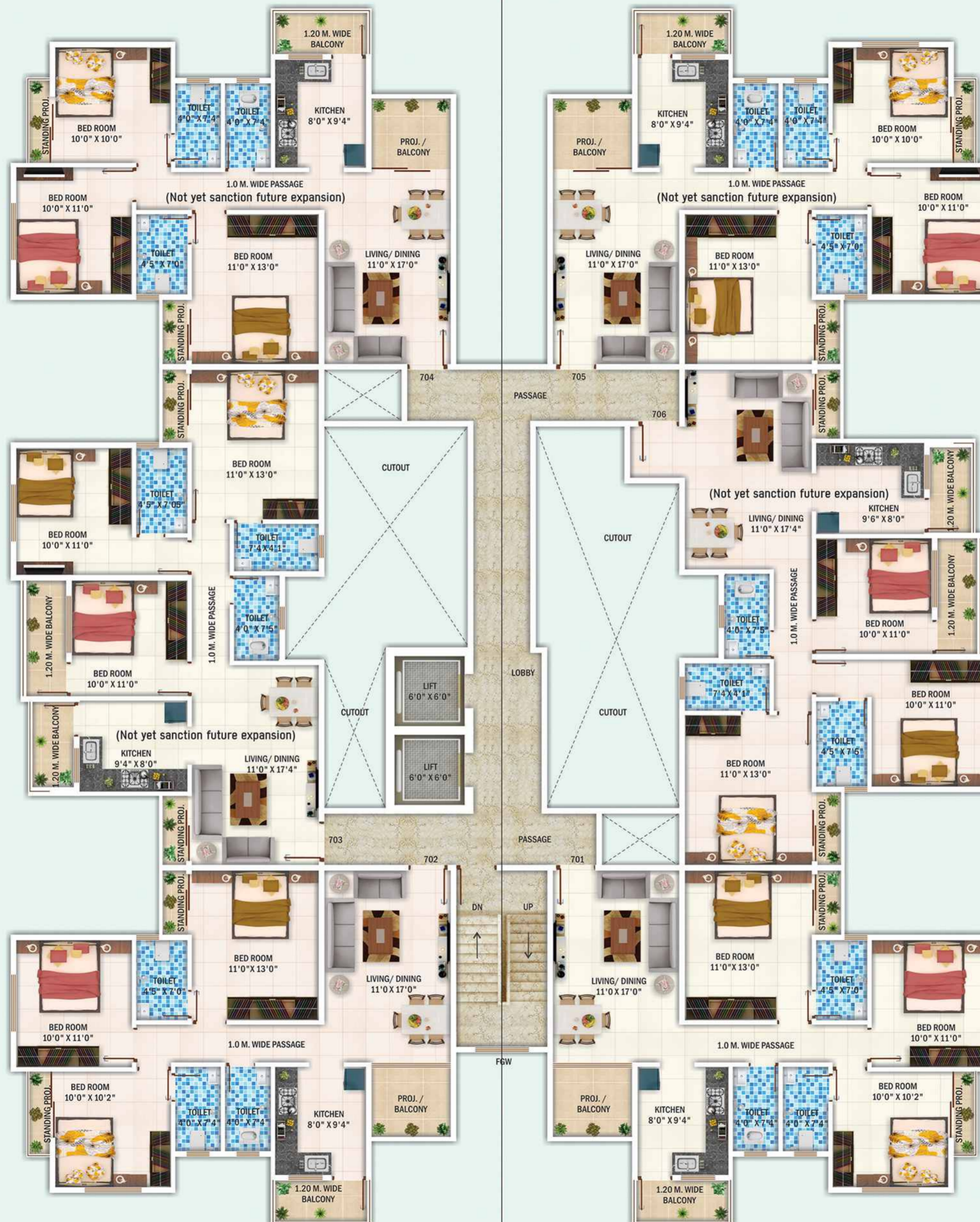

WING
MADHAV





Live natural life
in urban style

Plot No. 1 To 5, Behind Friends Colony, Near Center Point School, Hajaripahad, Nagpur.

FACILITIES



PROVISION FOR
FIRE FIGHTING



24 X 7
WATER SUPPLY



RAIN WATER
HARVESTING



AUTOMATIC WATER
LEVEL CONTROLLER



LAND SCAPE
IN COMMON AREA



UNDERGROUND
ELECTRIC NETWORK

INDOOR / OUTDOOR AMENITIES



INDOOR
PLAY AREA



INDOOR
GYM



MULTIPURPOSE
HALL



DESIGNER
ENTRANCE LOBBY



CCTV
SURVEILLANCE



JOGGING
TRACK



YOGA
CENTER



KIDS
INDOOR AREA



LIBRARY



LIFT & COMMON AREA
WITH POWER BACK-UP



GAZEBO



SENIOR CITIZEN
SITTING BENCH



Images used for representation purpose only.



SPECIFICATION

- ✓ **STRUCTURE**
Earthquake Resistant R.C.C frame structure.
- ✓ **WALLS**
External 150 mm thick brick masonry.
Internal 115 mm thick brick masonry.
- ✓ **PLASTER**
Outer wall 15 - 20 mm thick smooth finish.
Inner wall 12 mm thick phunt finish.
- ✓ **FLOORING**
Branded Vitrified tiles in entire flat.
Anti-Skid / Kota tiles in balconies.
Chequered Tiles in fire staircase.
- ✓ **DOORS & WINDOWS**
Main Door : B-Secure main entrance door.
Internal Doors : Flush Panel with RCC frame.
Windows : Aluminium Sliding Windows with oil painted MS safety grill on window only.
Aluminium adjustable louvers for bathroom.
- ✓ **ELECTRICAL**
ISI branded concealed wiring with circuit breakers.
Premium quality modular switches with adequate electric point.
AC point in master bedroom.
- ✓ **RAILING**
Railings for front balconies & staircases.
- ✓ **PARKING**
Ample space for Open / Covered Parking.
- ✓ **SAFETY**
Security Cabin, CCTV Surveillance in common areas.
- ✓ **COMMON AREAS**
Power back-up for common utilities.
- ✓ **KITCHEN**
Granite counter top with stainless steel sink, colour ceramic dado tiles upto lintel level, Power point for water purifier, washing machine & exhaust fan.
- ✓ **PAINTING FINISH**
Emulsion over the putty finished surface inner side.
Outer with Apex quality paint.
- ✓ **FALSE CEILING (POP)**
Contemporary design in hall.
- ✓ **PLUMBING**
Concealed plumbing with PVC Pipes, Colour Ceramic Dado Tiles up to lintel level, Sanitary ware & CP fittings of superior brand, Wall mixer for hot & cold water, Power point for geyser.
- ✓ **WATER SUPPLY**
Overhead Water Tank/Underground Water Tank /
Municipal Water Supply,
Rain Water Harvesting.
- ✓ **LIFT**
2 High Speed Elevators with power back-up.
- ✓ **NOTE**
 - M.S.E.B. meter & Water connection charges will be paid by the purchaser.
 - Building maintenance charges.
 - All legal charges towards the Govt. will be borne by the purchaser.
 - Documentation & legal fees will be paid by the purchaser.
 - Extra work other than standard specifications to be done as per item rate with 100% advance payment.
 - No deduction for any changes other than standard specifications.
 - GST and other statutory dues, if applicable will be charged extra.



PAYMENT SCHEDULE

At the Time of Booking	1,00,000/-
At the Time of Agreement	10%
At the Time of Plinth Level	10%
On or Before Ground Floor Slab	10%
On or Before 1st Floor Slab	10%
On or Before 2nd Floor Slab	10%
On or Before 3rd Floor Slab	10%
On or Before 4th Floor Slab	05%
On or Before 5th Floor Slab	05%
On or Before 6th Floor Slab	05%
On or Before 7th Floor Slab	05%
At the Time of Brick Work	05%
At the Time of Plaster	05%
At the Time of Finishing	05%
At the Time of Possession / Sale Deed	05%
Total	100%



Images used for representation purpose only.

LOCATION MAP

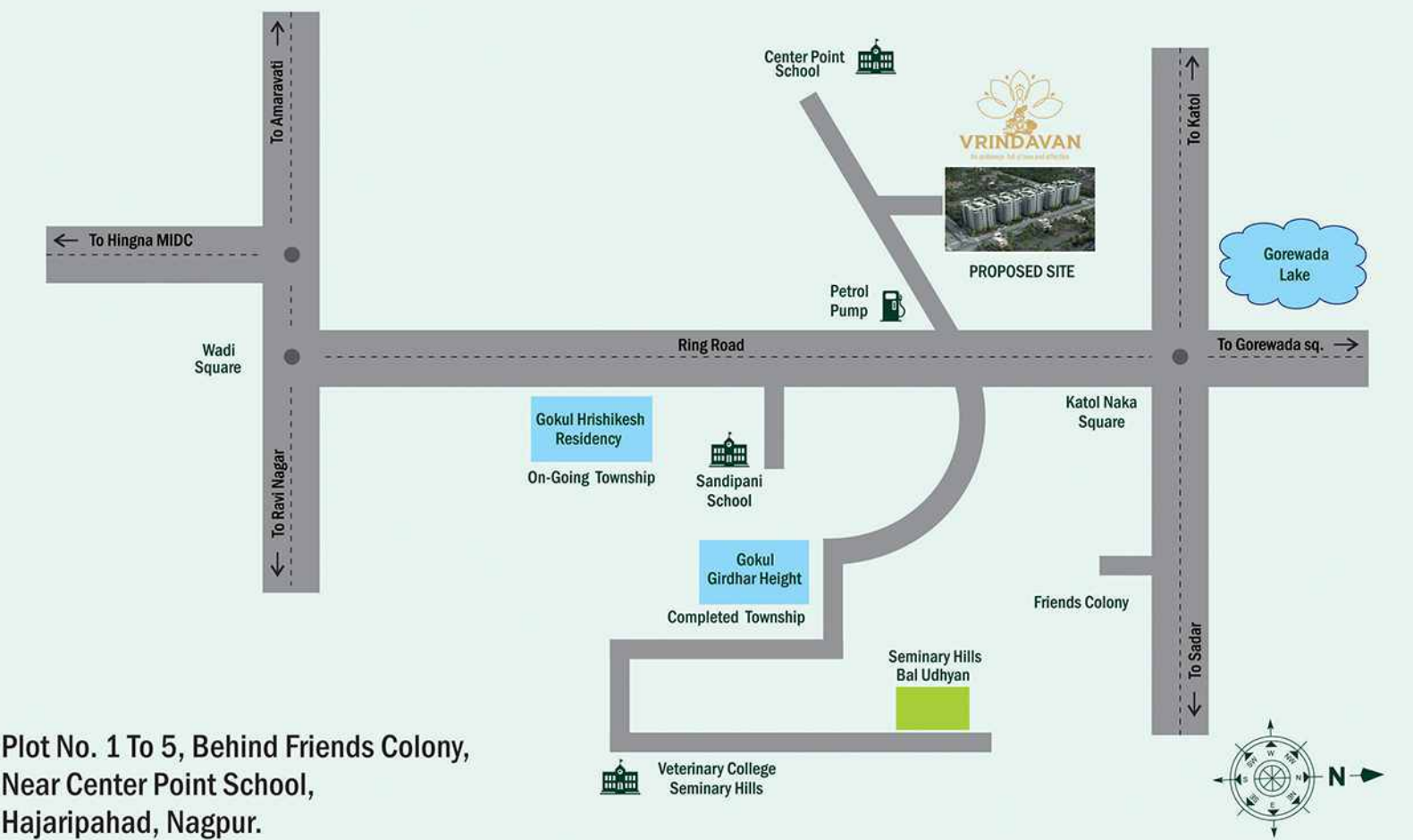

Plot No. 1 To 5, Behind Friends Colony,
Near Center Point School,
Hajarpahad, Nagpur.

A PROJECT BY



PANKAJ CONSTRUCTIONS

3, Gokul Keshav, Deo Nagar Square, Khamla Road,
Ajani, Nagpur-22. Visit Us : www.pankajconstructions.in